

Datasheet Nutform S45/29/13N3

S = Ridge width: 45/29/13mm
 N = Groove width: 3,0mm

VS 2022_7

S45/29/13N3-S



S45/29/13N3-B

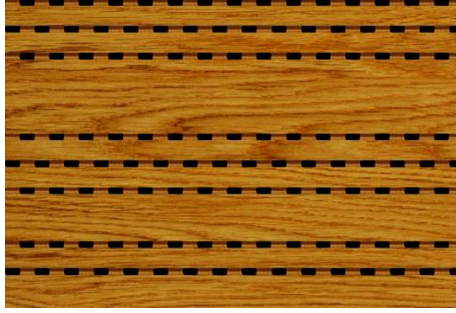

Open surface: 7,14%

- Applicable for
- Ceiling
 - Wall
 - Cabinet door
 - Partitioning
 - Lay In

PRODUCT OPTIONS Acoustic boards from Trikustik are manufactured to order and in a wide range of variants.

Perforation: Front side : grooved
 Back side: drilled (-B) or slotted holes (-S)

Acoustic fleece: black, laminated on back side

Thickness: 15-19mm depending on material / other thicknesses possible on request

Edges: as Format Paneel -> industrial cut
 as Format Lamelle -> lengthwise with tongue+groove connection

Options: Milling according to customer requirements

Formats: Lamelle (fix) + Paneel (variable)

Materials: MDF and many other materials

Surfaces: many options depending on material

Fire Protection: many options depending on material

ONLINE - Product Range Overview

→ available formats and measures

→ available materials

→ available surfaces and colors

→ options regarding fire protection



All product options always up to date

via QR code scan or via this link → www.trikustik.at/sortiment

Application: Information on planning, processing, installation and care: www.trikustik.at

SOUND ABSORPTION VALUES

Measurement: acc. to DIN EN ISO 354

Data source: certificate by LGA/TÜV

Valid for: application at wall and ceiling

Fleece: SP50 or equivalent

Insulation: Sonorock or equivalent

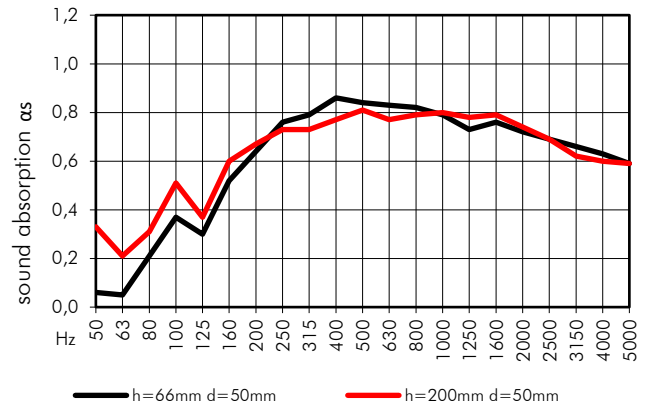
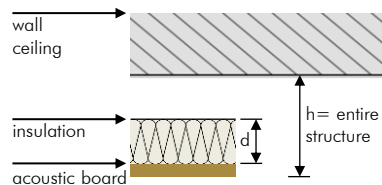

construction	Hz	50	63	80	100	125	160	200	250	315	400	500	630	800	1000	1250	1600	2000	2500	3150	4000	5000	
h=66mm d=50mm	α _s	0,06	0,05	0,21	0,37	0,30	0,52	0,64	0,76	0,79	0,86	0,84	0,83	0,82	0,79	0,73	0,76	0,72	0,69	0,66	0,63	0,59	α _w : 0,75
	α _p		0,10			0,40			0,75			0,85			0,80			0,70			0,65		SAA: 0,77
h=200mm d=50mm	α _s	0,33	0,21	0,31	0,51	0,37	0,60	0,67	0,73	0,73	0,77	0,81	0,77	0,79	0,80	0,78	0,79	0,74	0,69	0,62	0,60	0,59	α _w : 0,75
	α _p		0,30			0,50			0,70			0,80			0,80			0,75			0,60		SAA: 0,76