

Datasheet Nutform S30N2

VS_2022_7

S30N2-S



S30N2-B (normals S30N2-BG)

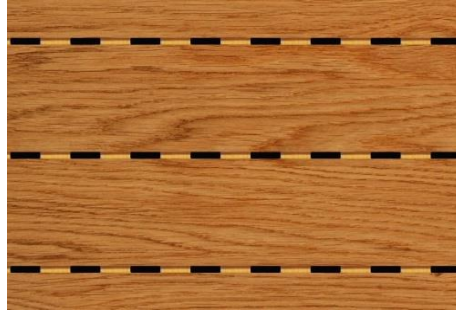

S = Ridge width: 30,0mm
N = Groove width: 2,0mm

Open surface: 3,13%

Applicable for
→ Ceiling
→ Wall
→ Cabinet door
→ Partitioning
→ Lay In

PRODUCT OPTIONS Acoustic boards from Trikustik are manufactured to order and in a wide range of variants.

Perforation: Front side : grooved
Back side: drilled (-B) or slotted holes (-S)

Acoustic fleece: black, laminated on back side

Thickness: 15-19mm depending on material / other thicknesses possible on request

Edges: as Format Paneel -> industrial cut
as Format Lamelle -> lengthwise with tongue+groove connection

Options: Milling according to customer requirements

Formats: Lamelle (fix) + Paneel (variable)

Materials: MDF and many other materials

Surfaces: many options depending on material

Fire Protection: many options depending on material

ONLINE - Product Range Overview

→ available formats and measures

→ available materials

→ available surfaces and colors

→ options regarding fire protection



All product options always up to date

via QR code scan or via this link → www.trikustik.at/sortiment

Application: Information on planning, processing, installation and care: www.trikustik.at

SOUND ABSORPTION VALUES

Measurement: acc. to DIN EN ISO 354

Data source: certificate by LGA/TÜV

Valid for: application at wall and ceiling

Fleece: SP50 or equivalent

Insulation: Sonorock or equivalent

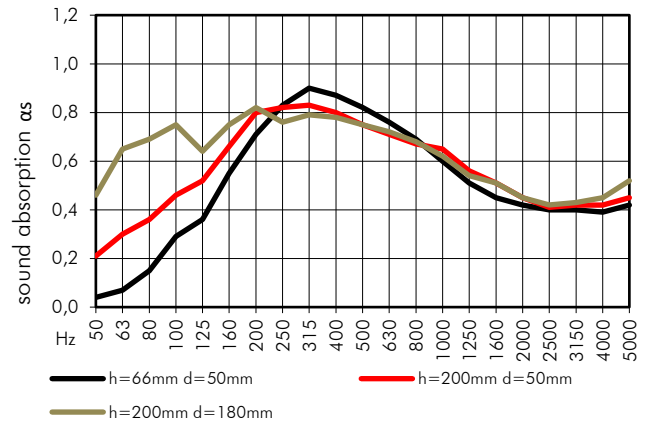
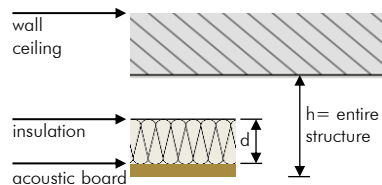

| construction | Hz | 50 | 63 | 80 | 100 | 125 | 160 | 200 | 250 | 315 | 400 | 500 | 630 | 800 | 1000 | 1250 | 1600 | 2000 | 2500 | 3150 | 4000 | 5000 | |
|--------------------|------------|------|------|------|------|------|------|------|------|------|------|------|------|------|------|------|------|------|------|------|------|------|-----------------------|
| h=66mm d=50mm | α_s | 0,04 | 0,07 | 0,15 | 0,29 | 0,36 | 0,55 | 0,71 | 0,83 | 0,90 | 0,87 | 0,82 | 0,76 | 0,69 | 0,60 | 0,51 | 0,45 | 0,42 | 0,40 | 0,40 | 0,39 | 0,42 | α_w : 0,50(LM) |
| | α_p | | 0,10 | | | 0,40 | | | 0,80 | | | 0,80 | | | 0,60 | | | 0,40 | | | | 0,40 | |
| h=200mm d=50mm | α_s | 0,21 | 0,30 | 0,36 | 0,46 | 0,52 | 0,66 | 0,80 | 0,82 | 0,83 | 0,80 | 0,75 | 0,71 | 0,67 | 0,65 | 0,56 | 0,51 | 0,45 | 0,41 | 0,42 | 0,42 | 0,45 | α_w : 0,55(L) |
| | α_p | | 0,30 | | | 0,55 | | | 0,80 | | | 0,75 | | | 0,65 | | | 0,45 | | | | 0,45 | |
| h=200mm d=180mm | α_s | 0,46 | 0,65 | 0,69 | 0,75 | 0,64 | 0,75 | 0,82 | 0,76 | 0,79 | 0,78 | 0,75 | 0,72 | 0,68 | 0,62 | 0,54 | 0,51 | 0,45 | 0,42 | 0,43 | 0,45 | 0,52 | α_w : 0,55(L) |
| | α_p | | 0,60 | | | 0,70 | | | 0,80 | | | 0,75 | | | 0,60 | | | 0,45 | | | | 0,45 | |