

Datasheet Nutform S13N3

VS_2022_7

S13N3-S



S13N3-B

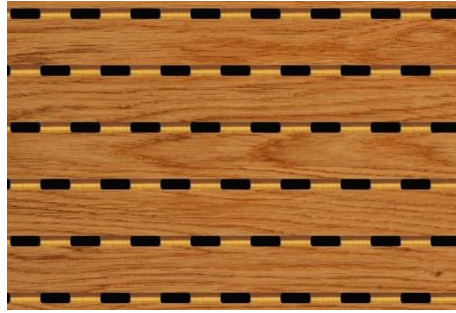

S = Ridge width: 13,0mm
N = Groove width: 3,0mm

Open surface: 9,38%

Applicable for
→ Ceiling
→ Wall
→ Cabinet door
→ Partitioning
→ Lay In

PRODUCT OPTIONS Acoustic boards from Trikustik are manufactured to order and in a wide range of variants.

Perforation: Front side : grooved
Back side: drilled (-B) or slotted holes (-S)

Acoustic fleece: black, laminated on back side

Thickness: 15-19mm depending on material / other thicknesses possible on request

Edges: as Format Paneel -> industrial cut
as Format Lamelle -> lengthwise with tongue+groove connection

Options: Milling according to customer requirements

Formats: Lamelle (fix) + Paneel (variable)

Materials: MDF and many other materials

Surfaces: many options depending on material

Fire Protection: many options depending on material

ONLINE - Product Range Overview

→ available formats and measures

→ available materials

→ available surfaces and colors

→ options regarding fire protection



All product options always up to date

via QR code scan or via this link → www.trikustik.at/sortiment

Application: Information on planning, processing, installation and care: www.trikustik.at

SOUND ABSORPTION VALUES

Measurement: acc. to DIN EN ISO 354

Data source: certificate by LGA/TÜV

Valid for: application at wall and ceiling

Fleece: SP50 or equivalent

Insulation: Sonorock or equivalent

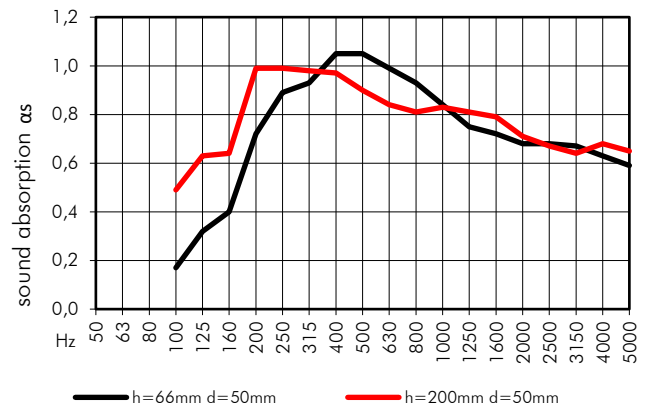
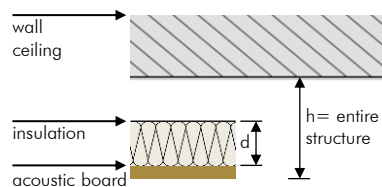

construction	Hz	50	63	80	100	125	160	200	250	315	400	500	630	800	1000	1250	1600	2000	2500	3150	4000	5000	
h=66mm d=50mm	α _s				0,17	0,32	0,40	0,72	0,89	0,93	1,05	1,05	0,99	0,93	0,84	0,75	0,72	0,68	0,68	0,67	0,63	0,59	α _w : 0,75(LM)
	α _p					0,30			0,85				1,05					0,70			0,65		SAA: 0,85
h=200mm d=50mm	α _s				0,49	0,63	0,64	0,99	0,99	0,98	0,97	0,90	0,84	0,81	0,83	0,81	0,79	0,71	0,67	0,64	0,68	0,65	α _w : 0,75(L)
	α _p					0,60			1,00			0,90			0,80			0,70			0,65		SAA: 0,86