

Datasheet Nutform S12N4

VS_2022_7

S12N4-S



S12N4-B

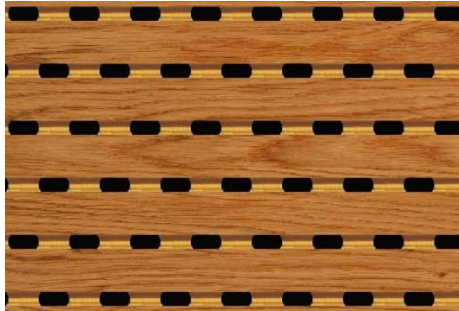

S = Ridge width: 12,0mm
N = Groove width: 4,0mm

Open surface: 12,50%

Applicable for
→ Ceiling
→ Wall
→ Cabinet door
→ Partitioning
→ Lay In

PRODUCT OPTIONS Acoustic boards from Trikustik are manufactured to order and in a wide range of variants.

Perforation: Front side : grooved
Back side: drilled (-B) or slotted holes (-S)

Acoustic fleece: black, laminated on back side

Thickness: 15-19mm depending on material / other thicknesses possible on request

Edges: as Format Paneel -> industrial cut
as Format Lamelle -> lengthwise with tongue+groove connection

Options: Milling according to customer requirements

Formats: Lamelle (fix) + Paneel (variable)

Materials: MDF and many other materials

Surfaces: many options depending on material

Fire Protection: many options depending on material

ONLINE - Product Range Overview

→ available formats and measures

→ available materials

→ available surfaces and colors

→ options regarding fire protection



All product options always up to date

via QR code scan or via this link → www.trikustik.at/sortiment

Application: Information on planning, processing, installation and care: www.trikustik.at

SOUND ABSORPTION VALUES

Measurement: acc. to DIN EN ISO 354

Data source: certificate by LGA/TÜV

Valid for: application at wall and ceiling

Fleece: SP50 or equivalent

Insulation: Sonorock or equivalent

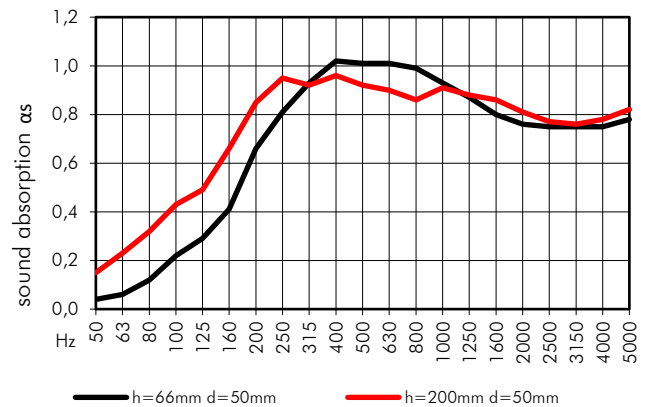
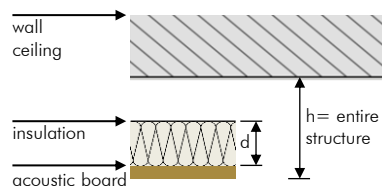

construction	Hz	50	63	80	100	125	160	200	250	315	400	500	630	800	1000	1250	1600	2000	2500	3150	4000	5000	
h=66mm d=50mm	α _s	0,04	0,06	0,12	0,22	0,29	0,41	0,66	0,81	0,93	1,02	1,01	1,01	0,99	0,93	0,87	0,80	0,76	0,75	0,75	0,75	0,78	α _w : 0,80
	α _p		0,05			0,30			0,80						0,95			0,75			0,75		SAA: 0,88
h=200mm d=50mm	α _s	0,15	0,23	0,32	0,43	0,49	0,66	0,85	0,95	0,92	0,96	0,92	0,90	0,86	0,91	0,88	0,86	0,81	0,77	0,76	0,78	0,82	α _w : 0,90
	α _p		0,25			0,55			0,90			0,95			0,90			0,80			0,80		SAA: 0,88