

Datasheet Mikroform M1 (R8D1.2ST)

VS_2022_7

R = Grid in mm: 8,0mm
 D = Diameter in mm: 1,2mm

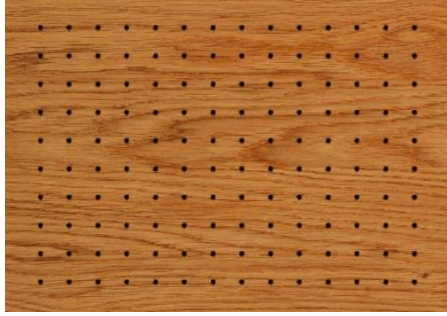

Open surface: 1,77%

- Applicable for
- Ceiling
 - Wall
 - Cabinet door
 - Partitioning
 - Lay In

PRODUCT OPTIONS Acoustic boards from Trikustik are manufactured to order and in a wide range of variants.

Perforation: Front side : Mikroperforation
 Back side: drilled

Acoustic fleece: black, laminated on back side

Thickness: 15-19mm depending on material / other thicknesses possible on request

Edges: as Format Paneel -> industrial cut
 as Format Lamelle -> lengthwise with tongue+groove connection

Options: unperforated friezes according to customer requirements

Formats: Lamelle (fix) + Paneel (variable)

Materials: MDF and many other materials

Surfaces: many options depending on material

Fire Protection: many options depending on material

ONLINE - Product Range Overview

→ available formats and measures

→ available materials

→ available surfaces and colors

→ options regarding fire protection



All product options always up to date

via QR code scan or via this link → www.trikustik.at/sortiment

Application: Information on planning, processing, installation and care: www.trikustik.at

SOUND ABSORPTION VALUES

Measurement: acc. to DIN EN ISO 354

Data source: certificate by LGA/TÜV

Valid for: application at wall and ceiling

Fleece: SP50 or equivalent

Insulation: Sonorock or equivalent

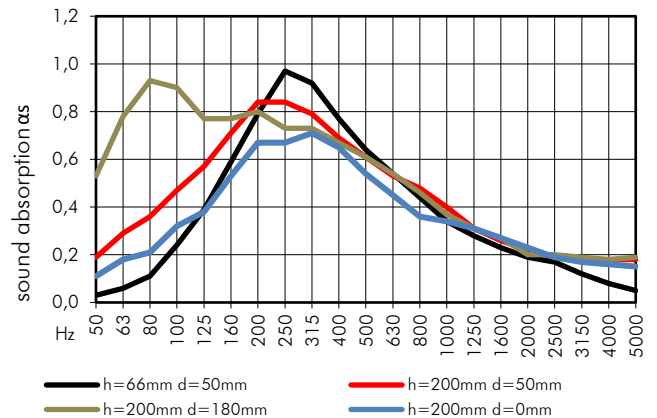
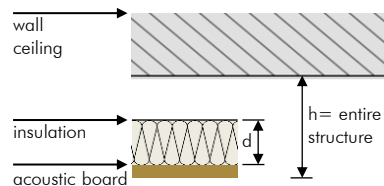

construction	Hz	50	63	80	100	125	160	200	250	315	400	500	630	800	1000	1250	1600	2000	2500	3150	4000	5000	
h=66mm d=50mm	α_s	0,03	0,06	0,11	0,24	0,39	0,59	0,79	0,97	0,92	0,77	0,64	0,54	0,44	0,34	0,28	0,23	0,19	0,17	0,12	0,08	0,05	α_w : 0,25 (LM)
	α_p		0,05			0,40			0,90			0,65			0,35			0,20			0,10		SAA: 0,52
h=200mm d=50mm	α_s	0,19	0,29	0,36	0,47	0,57	0,71	0,84	0,84	0,79	0,69	0,61	0,53	0,48	0,40	0,31	0,26	0,22	0,19	0,18	0,18	0,18	α_w : 0,30 (LM)
	α_p		0,30			0,60			0,80			0,60			0,40			0,20			0,20		SAA: 0,51
h=200mm d=180mm	α_s	0,53	0,78	0,93	0,90	0,77	0,77	0,80	0,73	0,73	0,67	0,61	0,54	0,46	0,37	0,31	0,27	0,20	0,20	0,19	0,18	0,19	α_w : 0,30 (LM)
	α_p		0,75			0,80			0,75			0,60			0,40			0,20			0,20		SAA: 0,49
h=200mm d=0mm	α_s	0,11	0,18	0,21	0,32	0,38	0,53	0,67	0,67	0,71	0,65	0,54	0,45	0,36	0,34	0,31	0,27	0,23	0,19	0,17	0,16	0,15	α_w : 0,30 (LM)
	α_p		0,15			0,40			0,70			0,55			0,35			0,25			0,15		SAA: 0,45