

Datasheet Mikroform L1 (R16D1.2ST)

VS_2022_7

R = Grid in mm: 16,0mm
 D = Diameter in mm: 1,2mm



Open surface: 0,44%

- Applicable for
- Ceiling
 - Wall
 - Cabinet door
 - Partitioning
 - Lay In

PRODUCT OPTIONS Acoustic boards from Trikustik are manufactured to order and in a wide range of variants.

Perforation: Front side : Mikroperforation
 Back side: drilled

Acoustic fleece: black, laminated on back side

Thickness: 15-19mm depending on material / other thicknesses possible on request

Edges: as Format Paneel -> industrial cut
 as Format Lamelle -> l lengthwise with tongue+groove connection

Options: unperforated friezes according to customer requirements

Formats: Lamelle (fix) + Paneel (variable)

Materials: MDF and many other materials

Surfaces: many options depending on material

Fire Protection: many options depending on material

ONLINE - Product Range Overview

→ available formats and measures

→ available materials

→ available surfaces and colors

→ options regarding fire protection



All product options always up to date

via QR code scan or via this link → www.trikustik.at/sortiment

Application: Information on planning, processing, installation and care: www.trikustik.at

SOUND ABSORPTION VALUES

Measurement: acc. to DIN EN ISO 354

Data source: certificate by LGA/TÜV

Valid for: application at wall and ceiling

Fleece: SP50 or equivalent

Insulation: Sonorock or equivalent

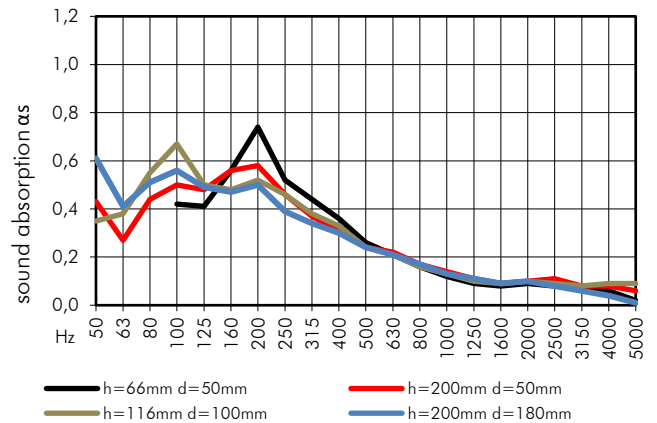
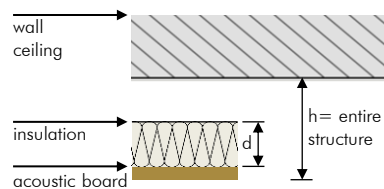

construction	Hz	50	63	80	100	125	160	200	250	315	400	500	630	800	1000	1250	1600	2000	2500	3150	4000	5000	
h=66mm d=50mm	α_s				0,42	0,41	0,56	0,74	0,52	0,44	0,36	0,26	0,21	0,16	0,12	0,09	0,08	0,09	0,08	0,07	0,06	0,02	α_w : 0,15 (L)
	α_p					0,45			0,55		0,30				0,10			0,10			0,05		SAA: 0,26
h=200mm d=50mm	α_s	0,43	0,27	0,44	0,50	0,48	0,56	0,58	0,46	0,37	0,31	0,24	0,22	0,17	0,14	0,11	0,09	0,10	0,11	0,08	0,08	0,06	α_w : 0,15 (L)
	α_p		0,40			0,50			0,45		0,25				0,15			0,10			0,05		SAA: 0,24
h=116mm d=100mm	α_s	0,35	0,38	0,55	0,67	0,50	0,48	0,52	0,46	0,38	0,33	0,24	0,21	0,16	0,13	0,10	0,09	0,10	0,09	0,08	0,09	0,09	α_w : 0,15 (L)
	α_p		0,45			0,55			0,45		0,25				0,15			0,10			0,10		SAA: 0,23
h=200mm d=180mm	α_s	0,61	0,41	0,51	0,56	0,49	0,47	0,50	0,39	0,34	0,30	0,24	0,21	0,17	0,13	0,11	0,09	0,10	0,08	0,06	0,04	0,01	α_w : 0,15 (L)
	α_p		0,50			0,50			0,40		0,25				0,15			0,10			0,05		SAA: 0,22