

Datasheet Lochform R8D3

VS_2022_7

R = Grid in mm: 8,0mm
 D = Diameter in mm: 3,0mm

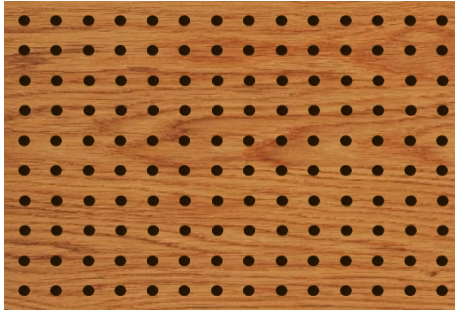

Open surface: 11,04%

- Applicable for
- Ceiling
 - Wall
 - Cabinet door
 - Partitioning
 - Lay In

PRODUCT OPTIONS Acoustic boards from Trikustik are manufactured to order and in a wide range of variants.

Perforation: Front side: drilled (through hole)

Acoustic fleece: black, laminated on back side

Thickness: 15-19mm depending on material / other thicknesses possible on request

Edges: as Format Paneel -> industrial cut

Options: unperforated friezes according to customer requirements

Formats: Paneel (variable)

Materials: MDF and many other materials

Surfaces: many options depending on material

Fire Protection: many options depending on material

ONLINE - Product Range Overview

→ available formats and measures

→ available materials

→ available surfaces and colors

→ options regarding fire protection



All product options always up to date

via QR code scan or via this link → www.trikustik.at/sortiment

Application: Information on planning, processing, installation and care: www.trikustik.at

SOUND ABSORPTION VALUES

Measurement: acc. to DIN EN ISO 354

Data source: certificate by LGA/TÜV

Valid for: application at wall and ceiling

Fleece: SP50 or equivalent

Insulation: Sonorock or equivalent

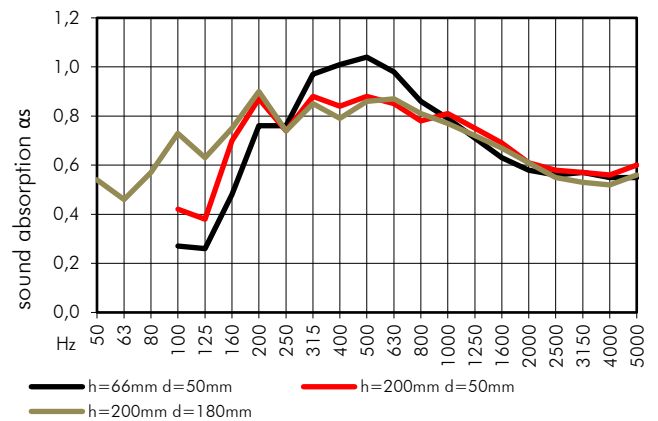
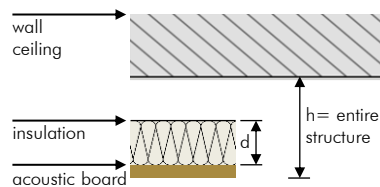

construction	Hz	50	63	80	100	125	160	200	250	315	400	500	630	800	1000	1250	1600	2000	2500	3150	4000	5000	
h=66mm d=50mm	alpha_s				0,27	0,26	0,48	0,76	0,76	0,97	1,01	1,04	0,98	0,86	0,79	0,71	0,63	0,58	0,56	0,57	0,55	0,55	alpha_w: 0,65 (M)
	alpha_p					0,35			0,85			1,00			0,80			0,60			0,55		SAA: 0,80
h=200mm d=50mm	alpha_s				0,42	0,38	0,70	0,87	0,74	0,88	0,84	0,88	0,85	0,78	0,81	0,75	0,69	0,61	0,58	0,57	0,56	0,60	alpha_w: 0,70 (L)
	alpha_p					0,50			0,85			0,85			0,80			0,65			0,60		SAA: 0,77
h=200mm d=180mm	alpha_s	0,54	0,46	0,57	0,73	0,63	0,75	0,90	0,74	0,85	0,79	0,86	0,87	0,81	0,77	0,72	0,67	0,61	0,55	0,53	0,52	0,56	alpha_w: 0,65 (L)
	alpha_p		0,50			0,70			0,85			0,85			0,75			0,60			0,55		SAA: 0,76