

Datasheet Lochform R16D8

VS_2022_7

R = Grid in mm: 16,0mm
 D = Diameter in mm: 8,0mm

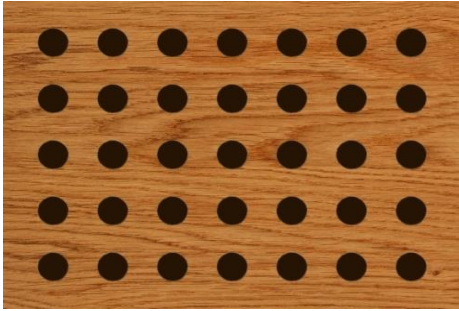

Open surface: 19,63%

- Applicable for
- Ceiling
 - Wall
 - Cabinet door
 - Partitioning
 - Lay In

PRODUCT OPTIONS Acoustic boards from Trikustik are manufactured to order and in a wide range of variants.

Perforation: Front side: drilled (through hole)

Acoustic fleece: black, laminated on back side

Thickness: 15-19mm depending on material / other thicknesses possible on request

Edges: as Format Paneel -> industrial cut

Options: unperforated friezes according to customer requirements

- Formats:** Paneel (variable)
- Materials:** MDF and many other materials
- Surfaces:** many options depending on material
- Fire Protection:** many options depending on material

ONLINE - Product Range Overview

→ available formats and measures

→ available materials

→ available surfaces and colors

→ options regarding fire protection



All product options always up to date via QR code scan or via this link → www.trikustik.at/sortiment

Application: Information on planning, processing, installation and care: www.trikustik.at

SOUND ABSORPTION VALUES

Measurement: acc. to DIN EN ISO 354

Data source: certificate by LGA/TÜV

Valid for: application at wall and ceiling

Fleece: SP50 or equivalent

Insulation: Sonorock or equivalent

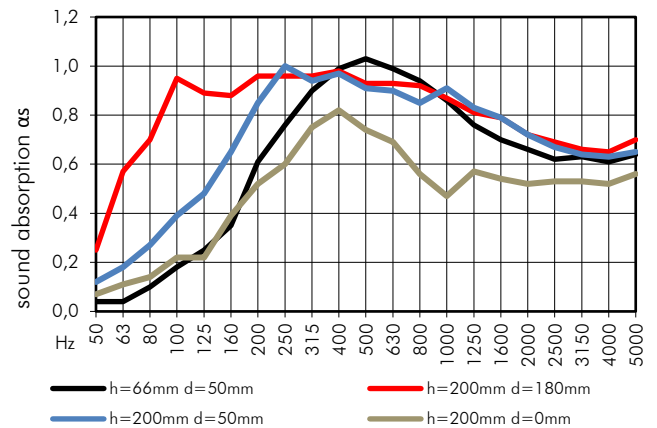
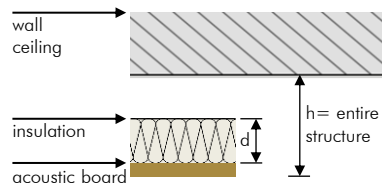

construction	Hz	50	63	80	100	125	160	200	250	315	400	500	630	800	1000	1250	1600	2000	2500	3150	4000	5000	
h=66mm d=50mm	α_s	0,04	0,04	0,10	0,18	0,25	0,35	0,61	0,76	0,90	0,99	1,03	0,99	0,94	0,86	0,76	0,70	0,66	0,62	0,63	0,61	0,64	α_w : 0,75 (M)
	α_p		0,05			0,25			0,75			1,00			0,85		0,65				0,65		SAA: 0,82
h=200mm d=50mm	α_s	0,12	0,18	0,27	0,39	0,48	0,65	0,85	1,00	0,94	0,97	0,91	0,90	0,85	0,91	0,83	0,79	0,72	0,67	0,64	0,63	0,65	α_w : 0,80 (L)
	α_p		0,20			0,50			0,95			0,95			0,85		0,75				0,65		SAA: 0,86
h=200mm d=0mm	α_s	0,07	0,11	0,14	0,22	0,22	0,39	0,52	0,60	0,75	0,82	0,74	0,69	0,56	0,47	0,57	0,54	0,52	0,53	0,53	0,52	0,56	α_w : 0,60
	α_p		0,10			0,30			0,60			0,75			0,55		0,55				0,55		SAA: 0,61
h=200mm d=180mm	α_s	0,25	0,57	0,70	0,95	0,89	0,88	0,96	0,96	0,96	0,98	0,93	0,93	0,92	0,87	0,81	0,79	0,72	0,69	0,66	0,65	0,70	α_w : 0,75 (L)
	α_p		0,50			0,90			0,95			0,95			0,85		0,75				0,65		SAA: 0,87