

# Datasheet Lochform R16D10

VS\_2022\_7

R = Grid in mm: 16,0mm  
D = Diameter in mm: 10,0mm

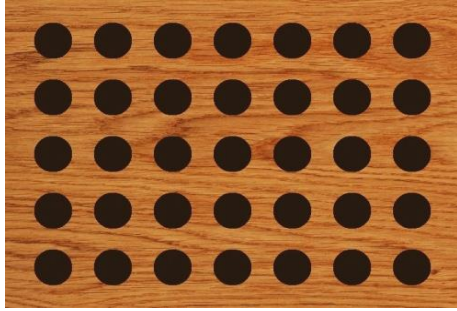

Open surface: 30,68%

- Applicable for
- Ceiling
  - Wall
  - Cabinet door
  - Partitioning
  - Lay In

**PRODUCT OPTIONS** Acoustic boards from Trikustik are manufactured to order and in a wide range of variants.

**Perforation:** Front side: drilled (through hole)

**Acoustic fleece:** black, laminated on back side

**Thickness:** 15-19mm depending on material / other thicknesses possible on request

**Edges:** as Format Paneel -> industrial cut

**Options:** unperforated friezes according to customer requirements

**Formats:** Paneel (variable)

**Materials:** MDF and many other materials

**Surfaces:** many options depending on material

**Fire Protection:** many options depending on material

**ONLINE - Product Range Overview**

→ available formats and measures

→ available materials

→ available surfaces and colors

→ options regarding fire protection



All product options always up to date

via QR code scan or via this link → [www.trikustik.at/sortiment](http://www.trikustik.at/sortiment)

**Application:** Information on planning, processing, installation and care: [www.trikustik.at](http://www.trikustik.at)

## SOUND ABSORPTION VALUES

**Measurement:** acc. to DIN EN ISO 354

**Data source:** certificate by TGM

**Valid for:** application at wall and ceiling

**Fleece:** SP50 or equivalent

**Insulation:** Sonorock or equivalent

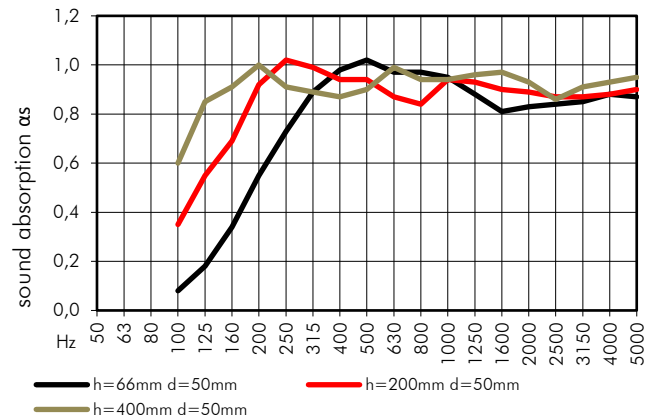
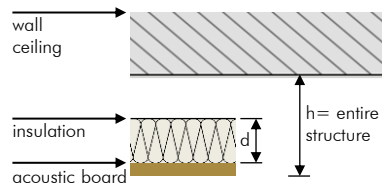

construction	Hz	50	63	80	100	125	160	200	250	315	400	500	630	800	1000	1250	1600	2000	2500	3150	4000	5000		
h=66mm d=50mm	α <sub>s</sub>				0,08	0,18	0,34	0,55	0,73	0,89	0,98	1,02	0,97	0,97	0,95	0,88	0,81	0,83	0,84	0,85	0,88	0,87		α <sub>w</sub> : 0,90
	α <sub>p</sub>					0,20			0,70			1,00			0,95			0,85			0,85			SAA: 0,87
h=200mm d=50mm	α <sub>s</sub>				0,35	0,55	0,69	0,92	1,02	0,99	0,94	0,94	0,87	0,84	0,94	0,93	0,90	0,89	0,87	0,87	0,88	0,90		α <sub>w</sub> : 0,90 (L)
	α <sub>p</sub>					0,55			1,00			0,90			0,90			0,90			0,90			SAA: 0,92
h=400mm d=50mm	α <sub>s</sub>				0,60	0,85	0,91	1,00	0,91	0,89	0,87	0,90	0,99	0,94	0,94	0,96	0,97	0,93	0,86	0,91	0,93	0,95		α <sub>w</sub> : 0,95
	α <sub>p</sub>					0,80			0,95			0,90			0,95			0,90			0,95			SAA: 0,93